

Project Report

Environment Park, Turin



The flat and pitched green roofs of the Environment Park.

Project Data

Total roof area: ca. 20.000 m²

Pitched roof area: ca. 5.000 m²

Construction Year: 1999

Architect/Design:
Emilio Ambasz, Benedetto Camerana
and Giovanni Durbiano

Contractor:
Perardi Giardini, Rivarolo Canavese

Coordinates:
45°05'16.37"N 7°40'18.58"E

Conception

Once, the river Dora was to disappear under a concrete slab in favour of a Fiat factory. But meanwhile, the Dora was freed and now it flows through a sprawling park.

The Environment Park was built on this industrial waste land from 1996 to 1999. It represents a total area of ca. 30.000 m², consisting of laboratories, offices and service centres. The entire

roof area of ca. 20.000 m² was greened. Seen from above, the Environment Park Turin looks like a system of living gardens.

The ZinCo System "Pitched Green Roof" was installed on the steeper roof areas (ca. 5.000 m²). This system transfers the shear forces into the sub-construction and provides the vegetation with water and nutrients.

System Build-up

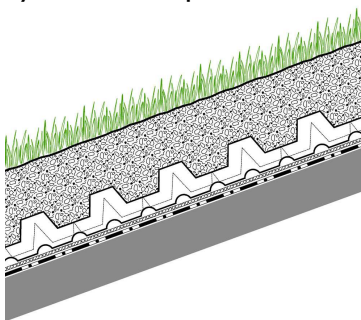

- Plant layer with Lawn and Ground Cover Shrubs
- System Substrate
- Floraset® FS 75
- Protection Mat SSM 45
- Roof construction with root resistant waterproofing

Development



Installation of the drainage element Floraset® FS 75 on the pitched green roof area.



After the substrate layer was applied.

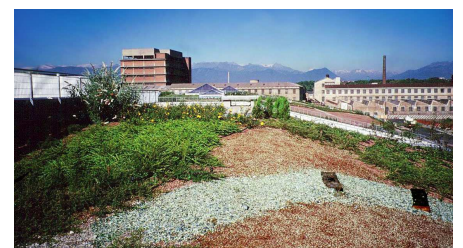

Little time after the planting with ground covering shrubs.



Low shrubs emphasize the sloped roof area too.

ZinCo GmbH

Lise-Meitner-Straße 2 · 72622 Nuertingen · Alemania
Teléfono +49 7022 6003 0 · Fax +49 7022 6003 100
info@zinco-greenroof.com · www.zinco-greenroof.com



Life on Roofs